

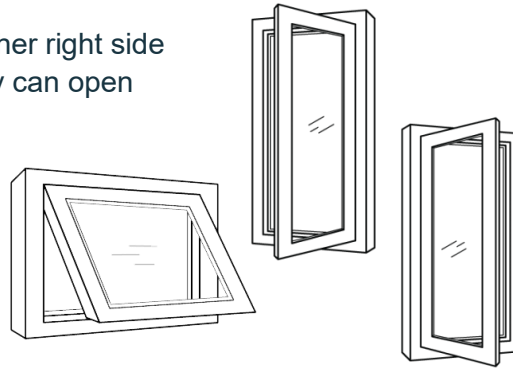

Casement Windows

Let the sunshine in with beautiful casement windows from Precision Millworks. Casements are the perfect choice for any window, but especially in locations where obstacles, such as sinks, countertops, or appliances, make a standard double-hung window harder to operate. Leave the expansive glass unobstructed or choose from our many popular grid light arrangements.

Casement windows can be either right side swing or left side swing or they can open from the top (also known as an awning window). 3/4" thick, double strength, insulated clear glass with Super Spacer® Warm Edge Technology dramatically minimizes energy loss, condensation, and noise.



Customize your window design with options, such as white or bronze hardware; pre-sets to open partially or fully, depending on the clearance needed; egress hinges to help meet local codes; and windows that are rated for coastal applications.

Complete window units for new construction and sash replacement kits for restorations and renovations are available. It's easy to change double-hung windows to casements with the ENVIROGUARD™ Casement Insert. Homeowners can have it all—beauty, full daylight view, and durability, all in less than 30 minutes per window install.

ENVIROGUARD
rot proof windows & millwork™

Casement windows are made of wood with an exterior ENVIROGUARD™ split sash constructed using the highest quality cellular PVC.

EASE

One-hand, operational ease with folding crank handle and levered multi-point locking system.



20 years on all glass and seals, and 25 years on PVC components. See complete warranty details on our website: PrecisionMillworks.com/Warranty



PRECISION MILLWORKS, INC.
www.precisionmillworks.com

Made in the USA with American pride and craftsmanship.



The ENVIROGUARD™ Story

Have peace of mind with Precision Millworks line of ENVIROGUARD windows and millwork because they **do not rot**. Built using ENVIROGUARD technology and 100% PVC, our products are paintable like wood, with the traditional look and feel of real wood, yet they won't rot. ENVIROGUARD is used on the sash, sill, and all exterior parts.

Finishing

ENVIROGUARD cellular PVC windows and millwork should be painted with standard oil base or latex paint using industry standard painting techniques after cleaning. ENVIROGUARD product extrusions are cellular PVC, a vinyl-based composite. As such, they may be subject to thermal expansion and contraction at direct temperatures above 145°F. Extremely dark colors may accelerate this situation as they tend to absorb a greater amount of solar heat potentially causing warping/distortion—distortion of frame and sash components, paint adhesion loss, blistering, and peeling can all result.

WARNING: Painting any ENVIROGUARD cellular PVC product with a paint color that has an L value of 56 or darker (black = 0 and white = 100) will forfeit the product warranty. If, despite the above warning, you should choose to paint ENVIROGUARD products a dark color (as defined above), a paint specifically designed for these applications **MUST** be used. Contact the paint manufacturer to verify the paint's reflective properties and suitability with regard to painting cellular PVC. Precision Millworks Inc. is not liable for paint used on our cellular PVC components or the result of its use.

*Meets the following Egress Requirements. Escape or rescue windows shall have a minimum net clear openable area of 5.7 square feet. The minimum net clear openable height of 24", width of 20", and a finished sill height not more than 44" above the floor. Verify your local code requirements prior to ordering.

**Special order Egress hinge available and must be specified when ordering. Note: Washability gap is eliminated when Egress hinge is used.

Outside Frame	Rough Opening	Egress	Egress w/ optional hinge
1/8 x 2/0	20 1/2" x 24 1/2"		
1/8 x 2/6	20 1/2" x 30 1/2"		
1/8 x 3/0	20 1/2" x 36 1/2"		
1/8 x 3/6	20 1/2" x 42 1/2"		
1/8 x 4/0	20 1/2" x 48 1/2"		
1/8 x 4/6	20 1/2" x 54 1/2"		
1/8 x 5/0	20 1/2" x 60 1/2"		
1/8 x 5/6	20 1/2" x 66 1/2"		
1/8 x 6/0	20 1/2" x 72 1/2"		
2/0 x 2/0	24 1/2" x 24 1/2"		
2/0 x 2/6	24 1/2" x 30 1/2"		
2/0 x 3/0	24 1/2" x 36 1/2"		
2/0 x 3/6	24 1/2" x 42 1/2"		
2/0 x 4/0	24 1/2" x 48 1/2"		
2/0 x 4/6	24 1/2" x 54 1/2"		
2/0 x 5/0	24 1/2" x 60 1/2"		
2/0 x 5/6	24 1/2" x 66 1/2"		
2/0 x 6/0	24 1/2" x 72 1/2"		
2/4 x 2/0	28 1/2" x 24 1/2"		
2/4 x 2/6	28 1/2" x 30 1/2"		
2/4 x 3/0	28 1/2" x 36 1/2"		
2/4 x 3/6	28 1/2" x 42 1/2"		
2/4 x 4/0	28 1/2" x 48 1/2"		
2/4 x 4/6	28 1/2" x 54 1/2"		
2/4 x 5/0	28 1/2" x 60 1/2"		
2/4 x 5/6	28 1/2" x 66 1/2"		
2/4 x 6/0	28 1/2" x 72 1/2"		**
2/6 x 2/0	30 1/2" x 24 1/2"		**
2/6 x 2/6	30 1/2" x 30 1/2"		**
2/6 x 3/0	30 1/2" x 36 1/2"		**
2/6 x 3/6	30 1/2" x 42 1/2"		**
2/6 x 4/0	30 1/2" x 48 1/2"		
2/6 x 4/6	30 1/2" x 54 1/2"		
2/6 x 5/0	30 1/2" x 60 1/2"		
2/6 x 5/6	30 1/2" x 66 1/2"	*	
2/6 x 6/0	30 1/2" x 72 1/2"	*	
3/0 x 2/0	36 1/2" x 24 1/2"		
3/0 x 2/6	36 1/2" x 30 1/2"		
3/0 x 3/0	36 1/2" x 36 1/2"		**
3/0 x 3/6	36 1/2" x 42 1/2"	*	
3/0 x 4/0	36 1/2" x 48 1/2"	*	
3/0 x 4/6	36 1/2" x 54 1/2"	*	
3/0 x 5/0	36 1/2" x 60 1/2"	*	
3/0 x 5/6	36 1/2" x 66 1/2"	*	
3/0 x 6/0	36 1/2" x 72 1/2"	*	
3/4 x 2/0	40 1/2" x 24 1/2"		
3/4 x 2/6	40 1/2" x 30 1/2"		**
3/4 x 3/0	40 1/2" x 36 1/2"	*	
3/4 x 3/6	40 1/2" x 42 1/2"	*	
3/4 x 4/0	40 1/2" x 48 1/2"	*	
3/4 x 4/6	40 1/2" x 54 1/2"	*	
3/4 x 5/0	40 1/2" x 60 1/2"	*	
3/4 x 5/6	40 1/2" x 66 1/2"	*	
3/4 x 6/0	40 1/2" x 72 1/2"	*	